



INSTRUCTION BULLETIN

No. 9013938
Machine: 800
Published: 11-2015
Rev. 00

NOTE: DO NOT DISCARD the Parts List from the Instruction Bulletin. Place the Parts List in the appropriate place in the machine manual for future reference. Retaining the Parts List will make it easier to reorder individual parts and will save the cost of ordering an entire kit.

NOTE: Numbers in parenthesis () are reference numbers for parts listed in Bill of Materials.

Installation instructions for **kit number 9013937**

SYNOPSIS:

This kit contains the parts needed to replace the A/C bracket on 800 sweepers equipped with CAT 3.4 diesel engines.
Please follow step-by-step instructions.

SPECIAL TOOLS / CONSIDERATIONS: NONE

(Estimated time to complete: 1.25 hours)

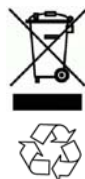

PROTECT THE ENVIRONMENT

Please dispose of packaging materials, used machine components such as batteries and fluids in an environmentally safe way according to local waste disposal regulations.

Always remember to recycle.

PREPARATION:

1. Park the machine on a clean level surface, turn off the machine, remove the key, and set the parking brake.

FOR SAFETY: Before leaving or servicing machine, stop on level surface, turn off machine, and remove key.

2. Open covers necessary to access the engine compartment.

INSTALLATION:

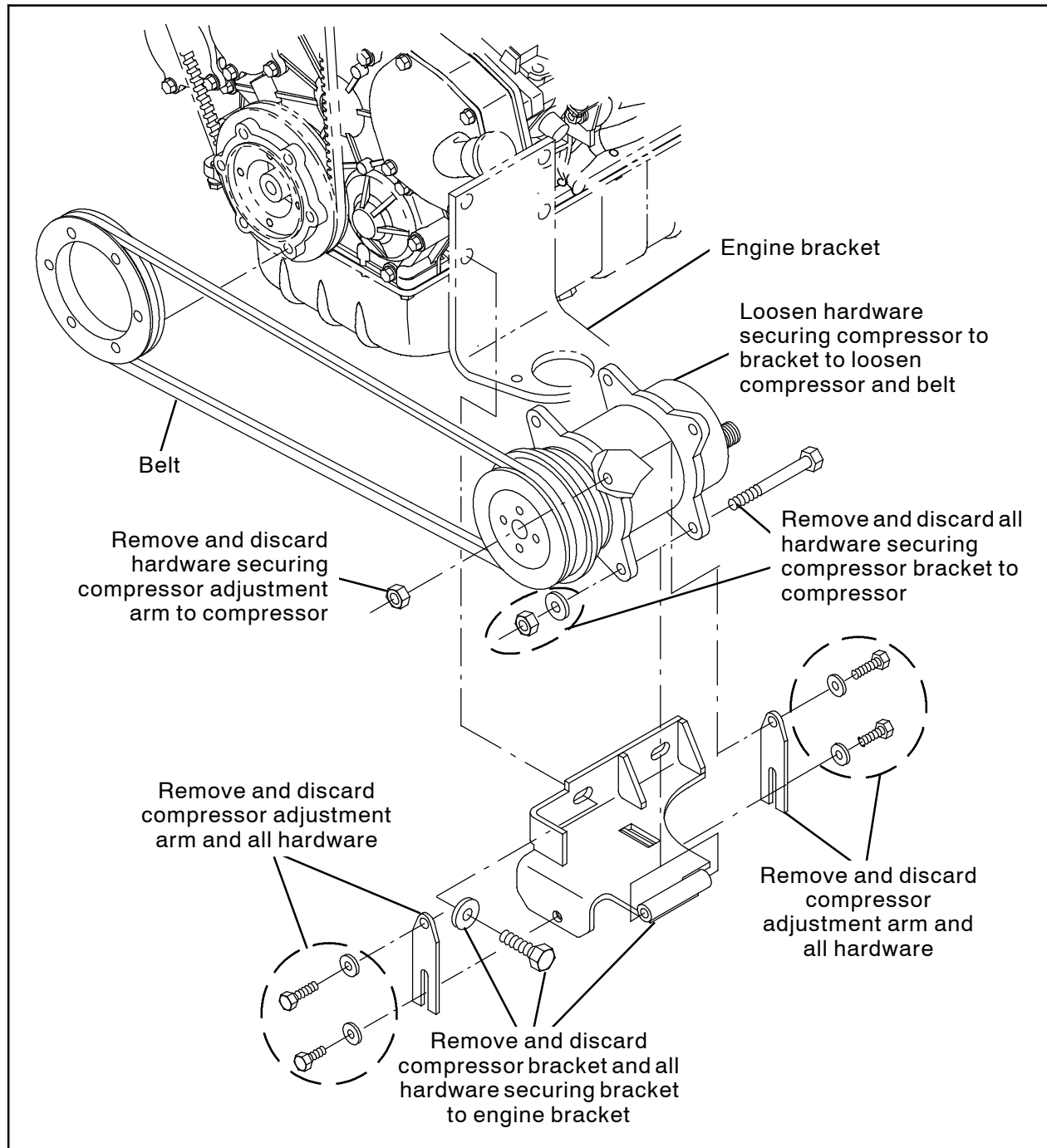

FIG. 1

1. Loosen the hardware securing the compressor to the machine to loosen the compressor and belt. (Fig. 1)
2. Remove the compressor adjustment arms from the machine. Discard the adjustment arms and all hardware. (Fig. 1)
3. Remove the compressor bracket from the compressor and the engine bracket. Discard the compressor bracket and all hardware. (Fig. 1)

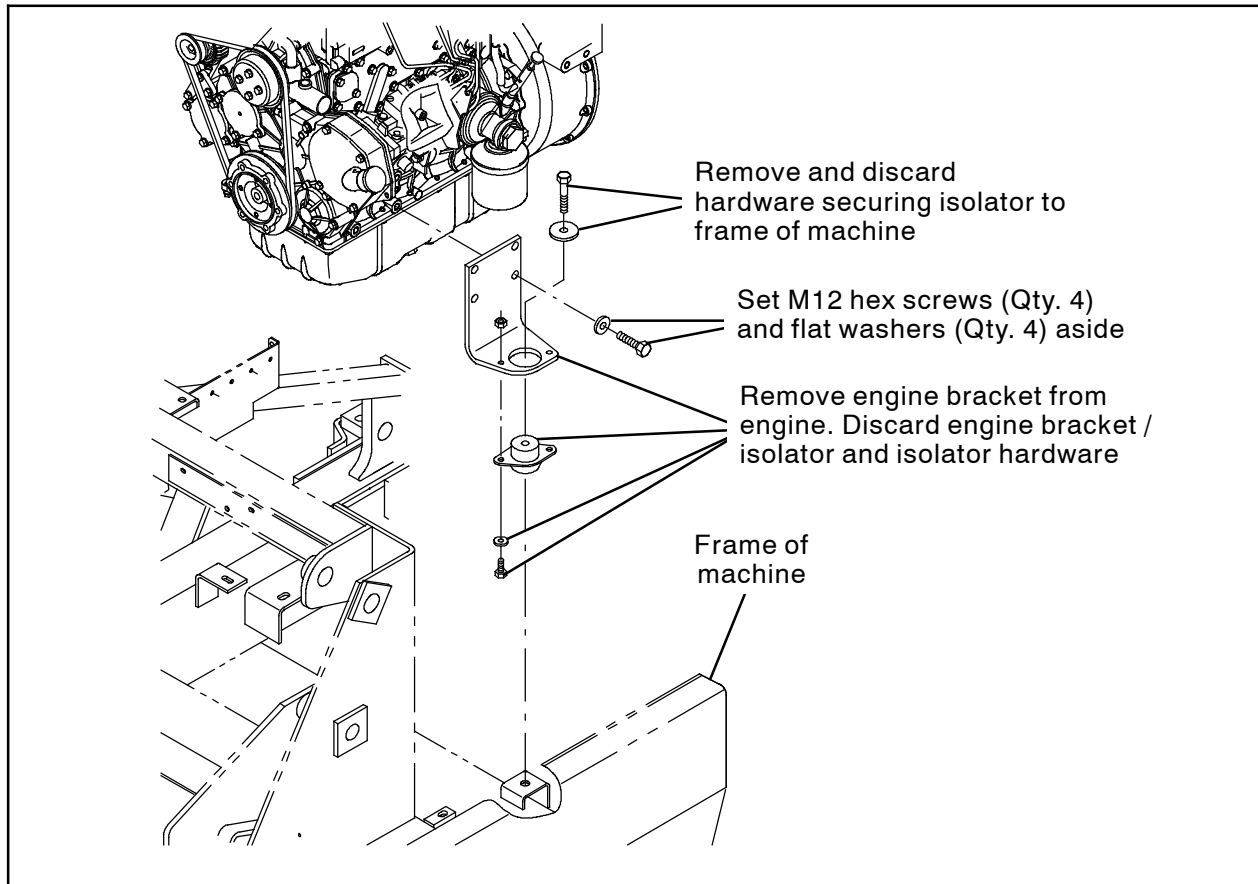

FIG. 2

4. Remove and discard the hardware securing the isolator / engine bracket to the frame of the machine. (Fig. 2)
5. Remove the engine bracket from the engine. Set the M12 hex screws (Qty. 4) and the flat washers (Qty. 4) aside. Discard the engine bracket / isolator and isolator hardware. (Fig. 2)
6. Use two hex screws (6), two flat washers (5), and two hex nuts (7) to install the new isolator (2) onto the new engine bracket (1). (Fig. 3)
7. Use two hex screws (13) and two flat washers (14) to install the compressor mounting bracket (16) onto the compressor bracket (8). (Fig. 3)
8. Use one M10 hex screw (10) and one flat washer (9) to install the compressor mounting bracket (16) onto the engine bracket (1). (Fig. 3)
9. Use the four M12 hex screws and four flat washers to install the A/C compressor bracket assembly assembled in the previous several steps onto the engine. (Fig. 3)
10. Use one M12 hex screw (4) and a flat washer (3) to secure the isolator (2) / engine bracket (1) to the frame of the machine. (Fig. 3)
11. Use one hex screw (15) and one flat washer (14) to install each compressor adjustment arm (11) onto the compressor. (Fig. 3)
12. Use two hex screws (15), two flat washers (14), and two lock hex nuts (7) to secure the compressor bracket (8) to the compressor. (Fig. 3)
13. Use one M8 hex screw (13) and one flat washer (12) to secure each compressor adjustment arm (11) to the compressor bracket (8). Adjust compressor / compressor adjustment arm as necessary. (Fig. 3)
14. Tighten the compressor / belt.
15. Start and test machine. Turn off machine and recheck the belt tension. Adjust belt tension as necessary.

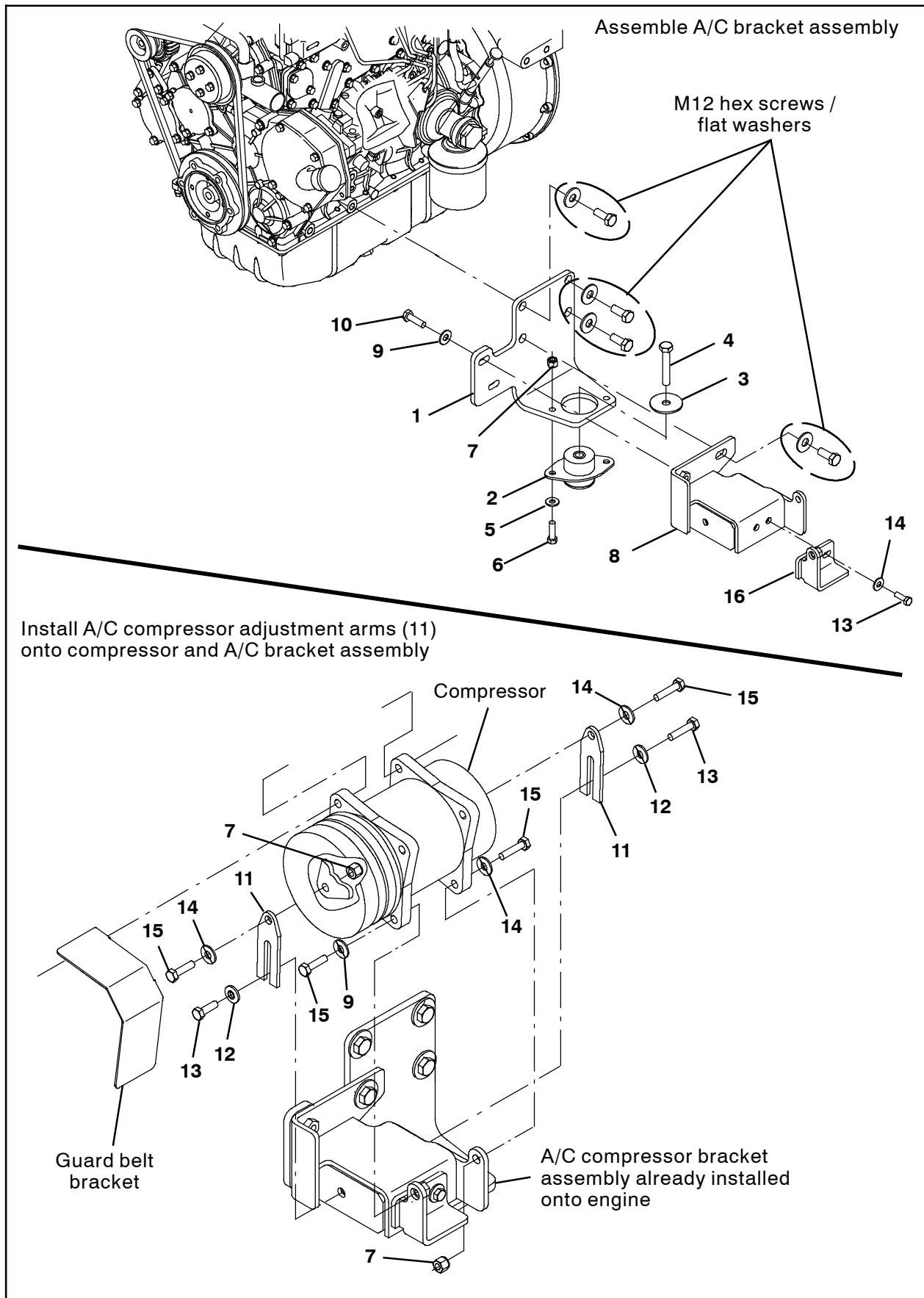

FIG. 3

Bill Of Materials For Bracket Kit, A/C, Replmt [800 CAT 3.4] - 9013937

Ref.	Tennant Part No.	Description	Qty.
1	1074500	Bracket, Mtg, Eng [800 CAT]	1
2	75768	Isolator, Vib, Flng, 2.0h .5B 2/.41H	1
3	57048	Washer, Flat, 0.53B 2.13D .11, STL, PL	1
4	06973	Screw, Hex, M12 X 1.75 X 70, 8.8	1
5	32491	Washer, Flat, 0.31, Std	2
6	21198	Screw, Hex, .38- 16 X 1.25, G5	2
7	50902	Nut, Hex, Lock, .38- 16, NL	5
8	1074502	Bracket Wldt, Compressor, A/C [800 CAT]	1
9	32492	Washer, Flat, 0.38, Std	2
10	39284	Screw, Hex, M10 X 1.50 X 35, 8.8	2
11	1073696	Arm, Adj, Compressor, A/C, .18 1.3W 4.0L	2
12	41186	Washer, Flat, Belleville, .31	2
13	39277	Screw, Hex, M8 X 1.25 X 25, 8.8	4
14	32491	Washer, Flat, 0.31, Std	6
15	36801	Screw, Hex, .38- 16 X 1.50, FL	4
16	1074473	Bracket, Mtg, Compressor	1

TENNANT COMPANY
P. O. Box 1452
Minneapolis, MN 55440-1452